

Kaiert is a company which designs,manufactures,sells and markets electric materials and has a wide range of product available to cover all your installation.

A wide spread sales organization offers our customers a rapid service.

At Kaiert we are always looking for young dynamic persons interested in joining a multinational company;in order to improve professional development ,we offer possibility of developing a solid working career.

Product safety is our most important assets ,and for this reason at Kaiert, we have a whole set of advanced equipments to ensure the product quility. Our company firmly carries out the ISO 90001-2008 standard.

Kaiert fuses protect power motor from the effects of shortcircuits because the super quick disconnect characteristic is far quicker than that of conventional . They protect expensive devices and system components such as converters with fuses in the input and in the AC link, UPS systems and soft starters for motors.

Specifications :

Ratings volts: 2000Vdc

Ratings Amps: 10A~150A

Main Aplication: high voltage motor aplication

Class : branch circuit protection -aR.

Agency Information : IEC269.4

$I^2t$  is lower in industry:

Faster and safer protection :



**Size  $\Phi$  51、 $\Phi$ 77    Rated Voltage DC 2000V    Class aR    Rated Breaking Capacity 50kA**

Current rating (A)	Catalog Number	Pre-arc $I^2t$ ( $A^2S$ )	Total $I^2t$ -value @DC 2000V ( $A^2S$ )	Power Loss (W)
10	S2080-10A/2000VDC	350	260	15
16	S2259-16A/2000VDC	1100	2000	17
17.5	S2258-17.5A/2000VDC	2900	4800	18
25	S2079-25A/2000VDC	6600	12000	19
30	S2078-30A/2000VDC	12000	19000	21
50	S2088-50A/2000VDC	20000	33000	23
60	S2077-60A/2000VDC	40000	66000	38
100	S2076-100A/2000VDC	78000	140000	45
150	S2075-150A/2000VDC	130000	210000	64

## Outline and installation

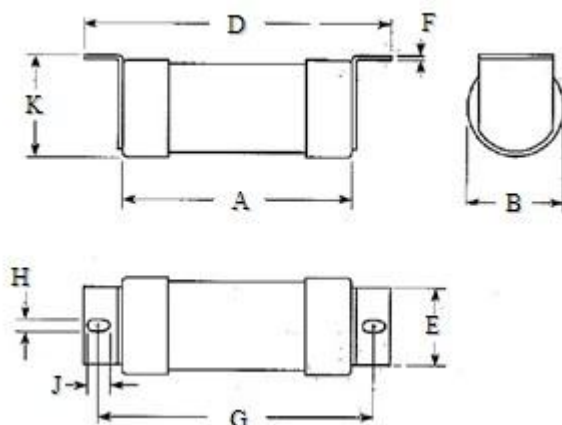

### Dimension

$U_e$ (V) DC	$I_e$ (A)	number	Dimension (mm)								
			A	B	D	E	F	G	H	J	K
2000V	10	S2080	190.5	51	257	45	3.2	235	10	13	55
2000V	16	S2259	190.5	51	257	45	3.2	235	10	13	55
2000V	17.5	S2258	190.5	51	257	45	3.2	235	10	13	55
2000V	25	S2079	190.5	51	257	45	3.2	235	10	13	55
2000V	30	S2078	190.5	51	257	45	3.2	235	10	13	55
2000V	50	S2088	190.5	51	257	45	3.2	235	10	13	55
2000V	60	S2077	190.5	77	257	64	3.2	235	10	13	81
2000V	100	S2076	190.5	77	257	64	3.2	235	10	13	81
2000V	150	S2075	190.5	77	257	64	3.2	235	10	13	81

TYPE  
2KV DC

H.R.C. Fuse-links

CUT-OFF CURRENT  
CHARACTERISTICS

AT TIME CONSTANT L/R=15MSEC

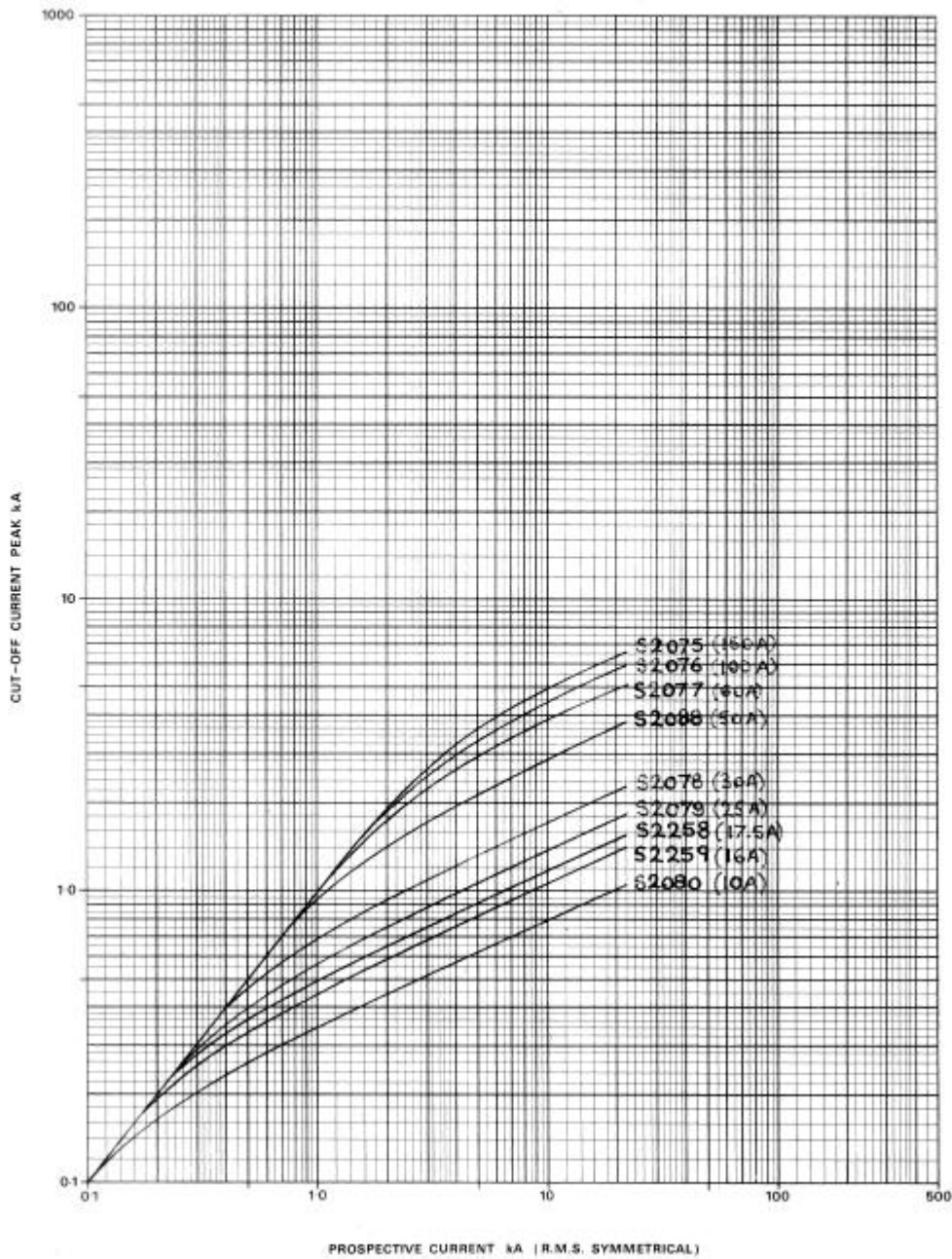

TYPE  
2KV DC

H.R.C. Fuse-links

CUT-OFF CURRENT  
CHARACTERISTICS

AT TIME CONSTANT L/R=15MSEC

